

FD19 Post Supported Roof Deck Flashing Detail

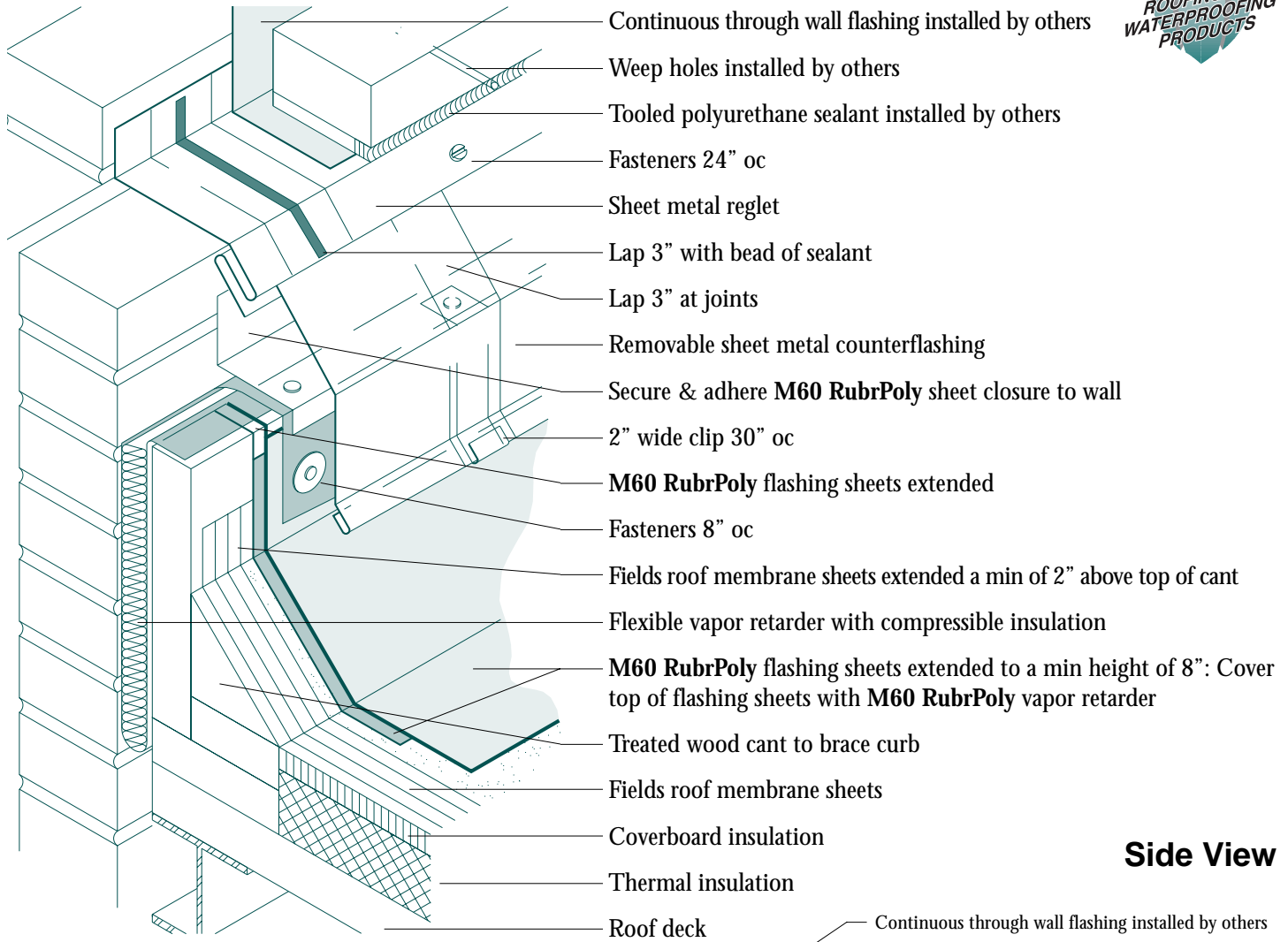

Side View

Notes

1. This detail should be installed where there is any possibility that differential movement will occur between the deck and a vertical surface. The wood members should not be fastened to the wall.
2. The joints in the sheet metal counterflashing shall not be soldered.
3. Attach treated wood nailer to deck with suitable fasteners.
4. This detail is not for use with lightweight fills.

