

# FD09 Roof-Top Chimney Pipe Detail

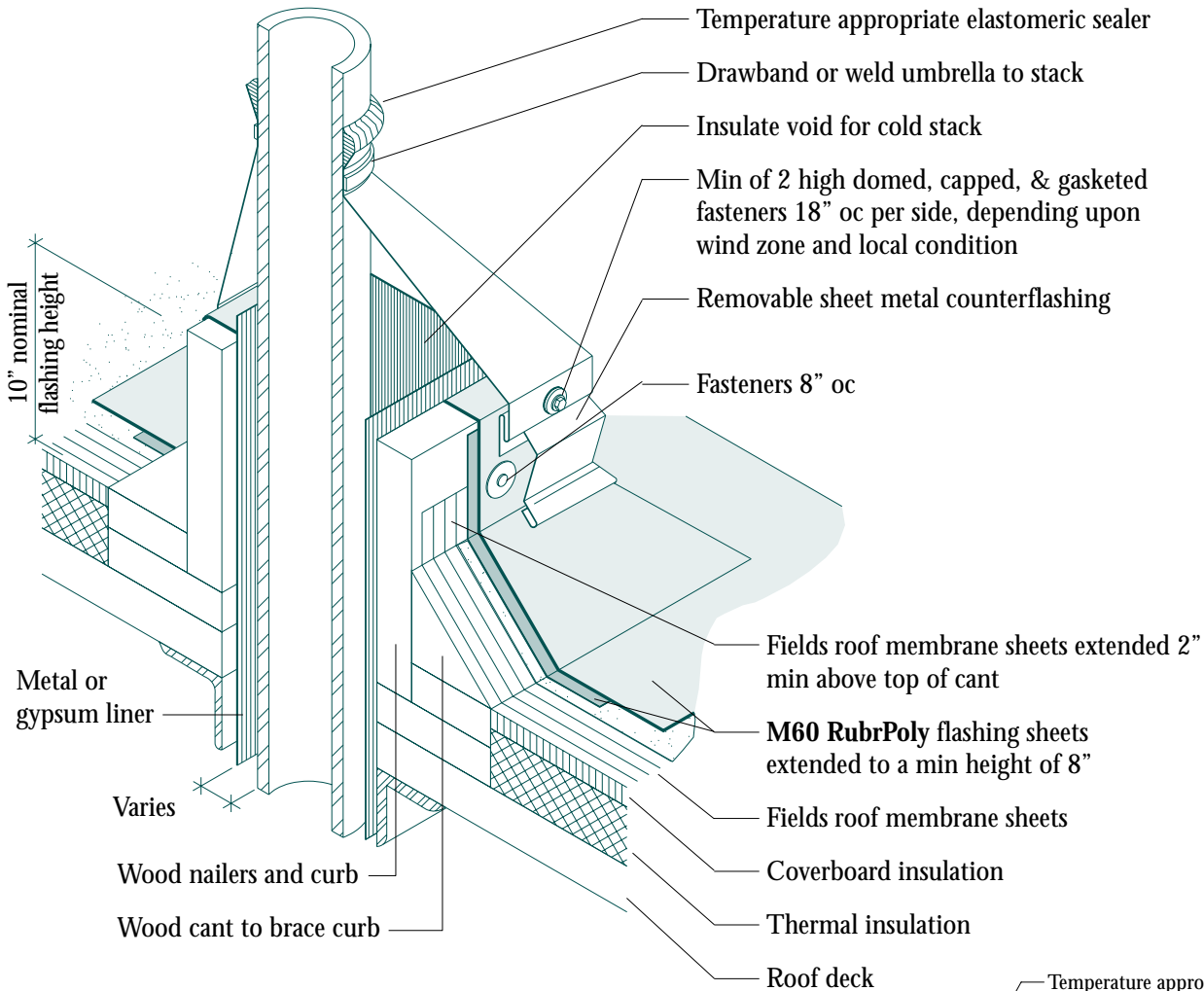

**Side View**

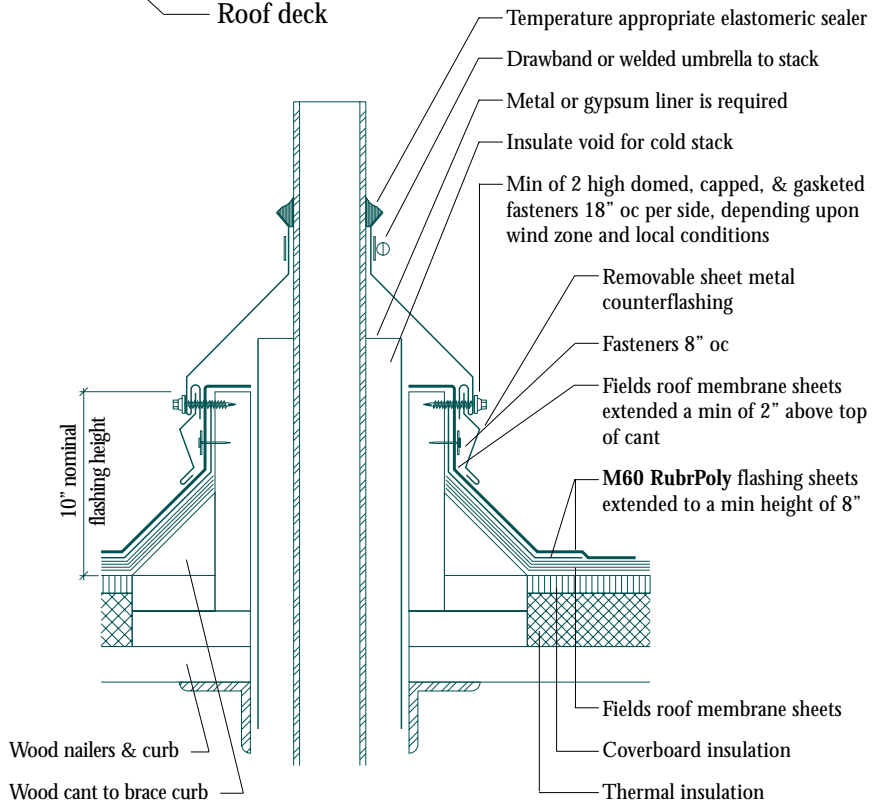

## Notes

1. This detail allows the opening to be completed before the stack is placed.
2. The clearance necessary between the gypsum or metal liner and the stack, and the need for insulation, will depend on the temperature of the material emitted through the stack.
3. Attach treated nailer to the deck with suitable fasteners.