

# FD06 Roof-Top Metal Air Shaft Curb Detail

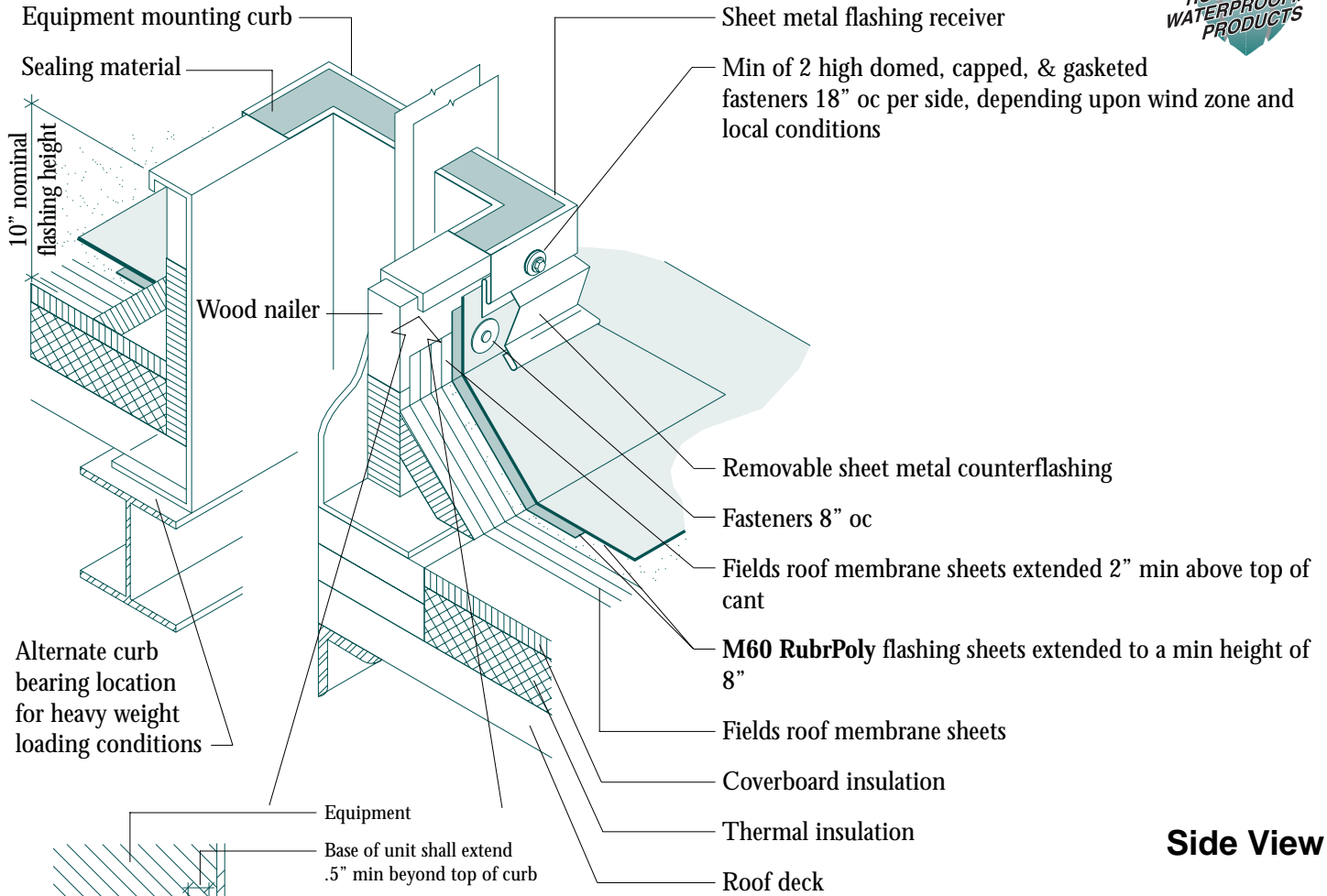

**Side View**

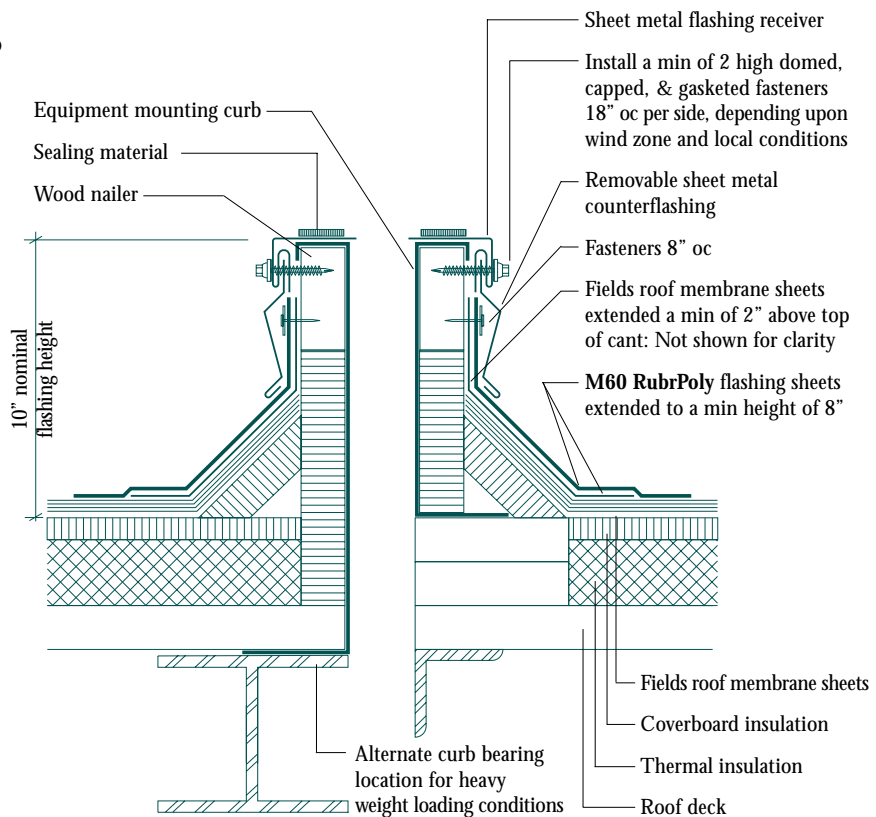
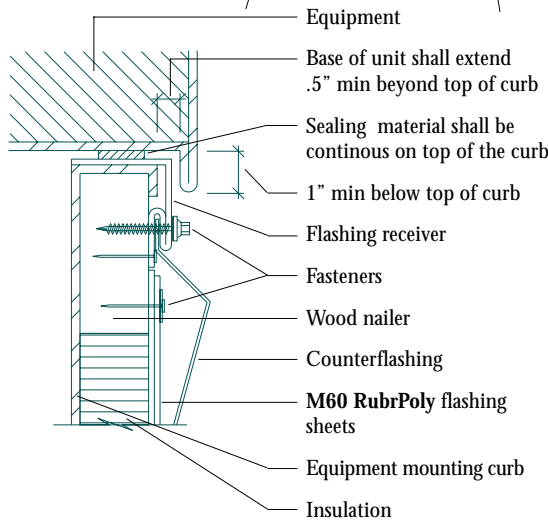

## Notes

1. The top wood nailer of the curb & the seal strip shall be supplied by the curb manufacturer.
2. Attach the treated wood nailer to deck with suitable fasteners.
3. Mechanical units shall be installed after the roof membrane and flashings have been installed.