

FD05 Roof-Top Equipment Curb Detail

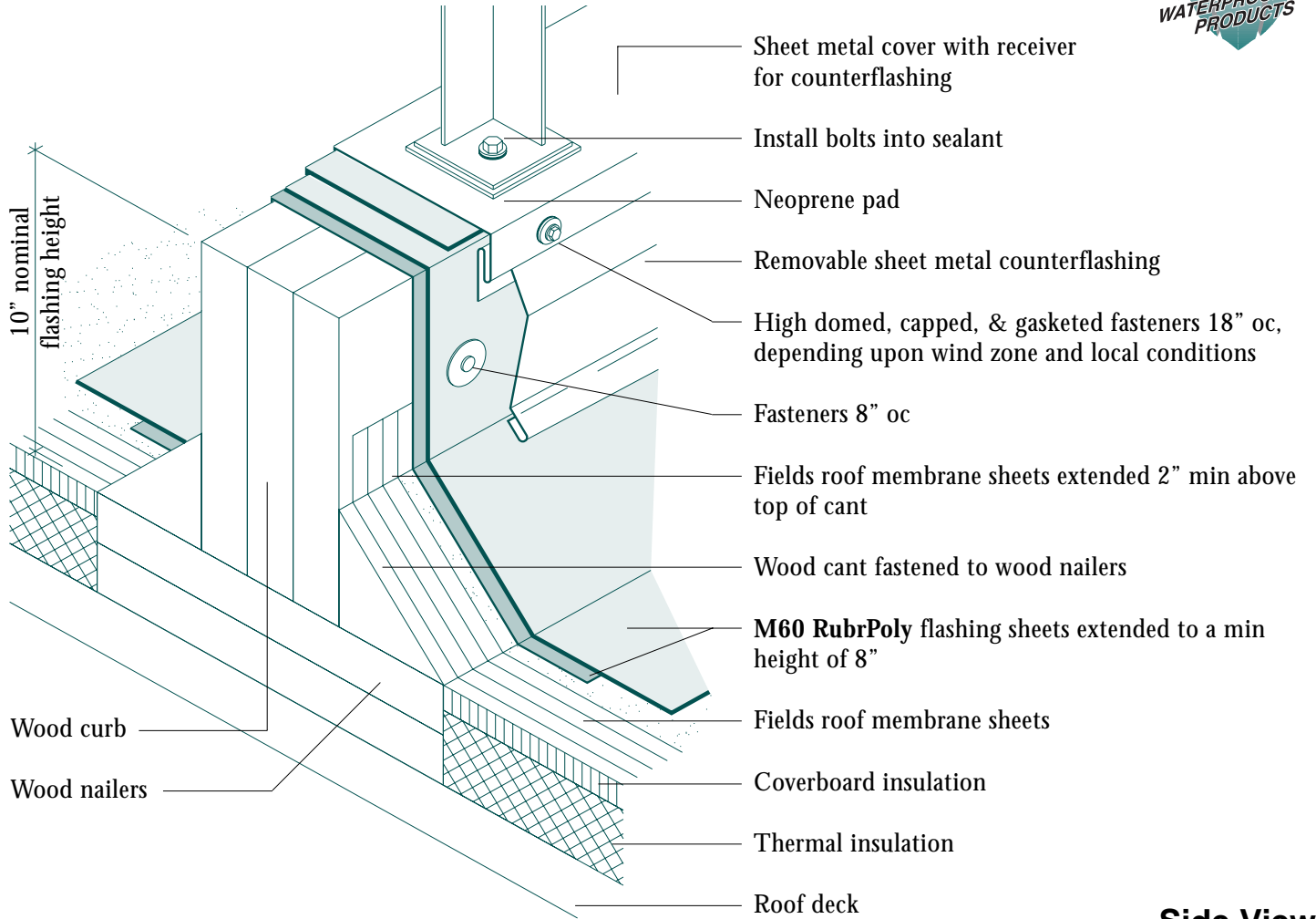

Side View

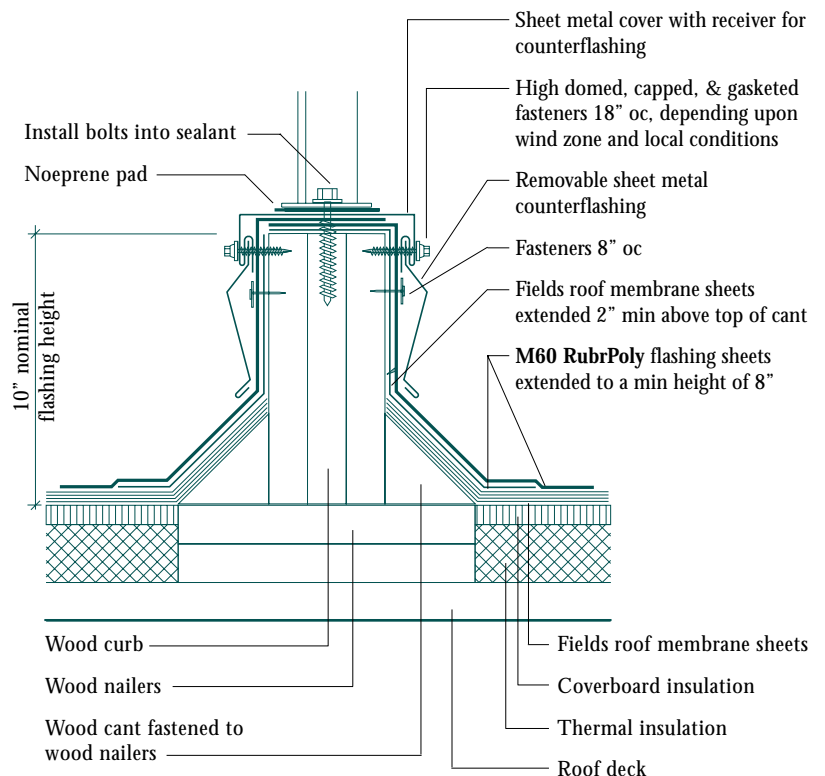

Notes

1. This detail allows for roof maintenance around supported equipment. The continuous support design shall be installed in light weight structural systems so as to distribute the equipment weight across two or more structural support members. A min of 2' of horizontal clearance shall be provided for removal and replacement of roofing and flashing between parallel supports. A min of 3' of vertical clearance from roof surface to bottom of supported equipment shall be provided.
2. Attach wood nailer to deck with suitable fasteners.